

(Set out D-38-142)

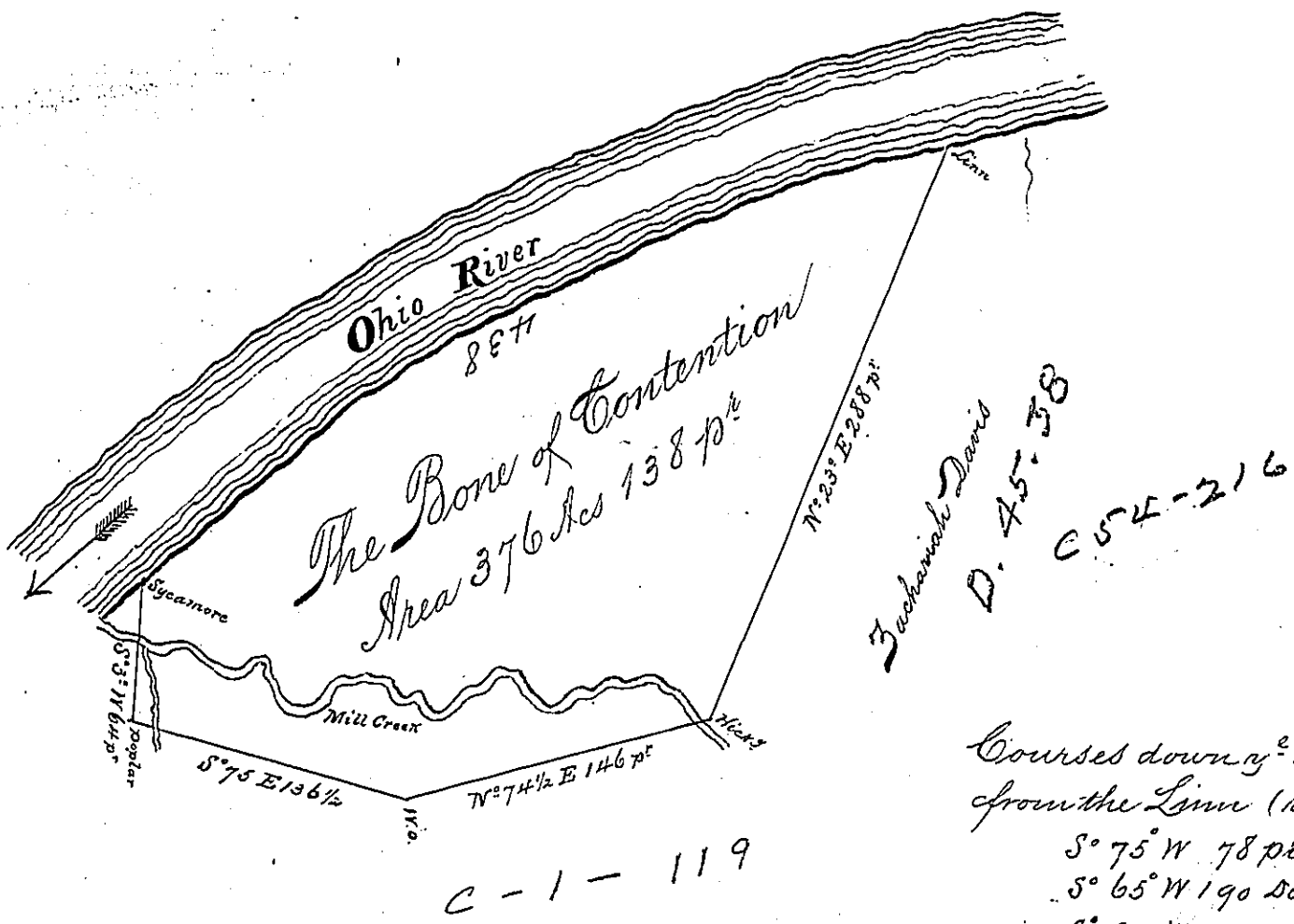

Courses down ^e River
 from the Linn (orig)
 S° 75° W 78 pt
 S° 65° W 190 Do
 S° 52° W 170 Do to the
 Sycamore —
 438

A Draught of a Survey called the Bone of Contention lying on the Ohio River in Washington County cont^y 376 Acs 138 Pts strict Measure executed Feb^y 11th 1786 in consequence of a Certificate obtained from the Commis^r appointed by Virg^a to adjust the Titles to unpatented Lands in Monongahela Ton^{ga} & Ohio in y^e name of Jas^s Henderson for 400 Acs and duly entered with the County Surveyor as appears from y^e List of Entries transmitted to us from the Survey^r Genl^t Office. Ent^d 26th Apr^l 1780. - Jas^s Henderson has conveyed his Right to Rob^t Doune Dawson, who wishes the Patent to issue Board of Property by their Judg^t of the Presley Neville } by
 2^d March 1790 Allow Patent to issue on this Math^w Ritchie } D. Surv^r
 to Dawson
 John Lukens Esq^r S. Gen^t }

Note. the above Draught includes the whole of a Survey of 206 Acs 893 Pts made on a Warrant from ^e Office of this State in y^e name of Rob^t McPherson for 300 Acs dated Feb^y 18th 1785 (D-38-142) N. & R. Unpatented.

IN TESTIMONY that the above is a copy of the original remaining on file in the Department of Internal Affairs of Pennsylvania, made conformably to an Act of Assembly approved the 16th day of February, 1833. I have hereunto set my Hand and caused the Seal of said Department to be affixed at Harrisburg, this twenty fifth day of July 1895.

James W. Latta
 Secretary of Internal Affairs.